

Current part is item (6) on diagram. Available at www.oshkoshequipment.com

(1) SMR Code	(2) Federal Stock Number	DESCRIPTION	UNIT of meas	(4) Qty inc. in Unit	30-day DS maint allowance			30-day GS maint allowance			1-yr alw per 100 equip cnt- gcy	Depot maint alw per 100 equip	Illustration	
					(a) 1-20	(b) 21-50	(c) 51-100	(a) 1-20	(b) 21-50	(c) 51-100			(a) Figure No.	(b) Item No.
		Reference Number & Mfr. Code												
PAHZZ	5340-850-3997	WASHER, FLAT: GEAR RETAINING 10889876 (19207)	EA	1	*	*	*	*	*	*	*	8	12	
PAHZZ	3020-851-8970	GEAR, HELICAL: OIL PUMP IDLER 10889818 (19207)	EA	1	*	*	*	*	*	*	*	8	13	
PAHZZ	3110-156-4681	BEARING, BALL, ANNULAR: IDLER GEAR SHAFT 5204KD (21335)	EA	1	*	*	*	*	*	*	*	8	14	
PAHZZ	5365-543-4110	RING, RETAINING: BEARING MS16625-3185 (96906)	EA	1	*	*	*	*	*	*	*	8	15	
PAHZZ	5310-899-5941	WASHER, FLAT: GEAR BEARING 10889966 (18876)	EA	1	*	*	*	*	*	*	*	8	16	
PAHZZ	5365-850-3994	RING, RETAINING: BEARING 7748862 (19207)	EA	1	*	*	*	*	*	*	*	8	17	
PAFZZ	2815-885-3430	OIL PAN, ENGINE CRANKCASE: 10899065 (19207)	EA	1	*	*	*	*	*	*	*	8	18	
PAOZZ	5365-196-6710	SPACER, RING: DRAIN PLUG AN901-10C (88044)	EA	2	*	*	*	*	*	*	*	8	19	
PAOZZ	5365-288-8483	PLUG, MACHINE THREAD, MAGNETIC: OIL PAN DRAIN 445097 (24617)	EA	2	*	*	*	*	*	*	*	8	20	
PAFZZ	5305-269-3211	SCREW, CAP, HEXAGON HEAD: OIL PAN MTG MS90725-60 (96906)	EA	27	*	*	*	*	*	*	*	8	21	
PAFZZ	5310-959-4675	WASHER, LOCK: OIL PAN MTG MS35340-46 (96906)	EA	27	*	*	*	*	*	*	*	8	22	
PAFZZ	5330-885-3422	GASKET: OIL PAN 10889730 (19207)	EA	1	*	*	*	*	*	*	*	8	23	
PAFZZ	5310-813-1203	NUT, FLAIN, SLOTTED, HEXAGON: GEAR MTG 102647 (24617)	EA	1	*	*	*	*	*	*	*	9	1	
PAFZZ	5315-241-7330	PIN, COTTER: GEAR NUT MS24665-304 (96906)	EA	1	*	*	*	*	*	*	*	9	2	
PAFZZ	3020-067-4890	GEAR, HELICAL: OIL PUMP DRIVE 104935176 (19207)	EA	1	*	*	*	*	*	*	*	9	3	
PAFZZ	5310-682-5930	WASHER, LOCK: TUBES AND TUBE BRACKET MTG MS35340 (96906)	EA	8	*	*	*	*	*	*	*	9	4	
PAFZZ	5305-071-2231	SCREW, CAP, HEXAGON HEAD: TUBES MTG MS90725-20 (96906)	EA	6	*	*	*	*	*	*	*	9	5	
PAFZZ	5330-078-8998	GASKET: OIL PUMP PICKUP TUBE 10935201 (19207)	EA	1	*	*	*	*	*	*	*	9	6	
PAFZZ	5305-068-0502	SCREW, CAP, HEXAGON HEAD: TUBES AND CLAMPS MS90725-6 (96906)	EA	5	*	*	*	*	*	*	*	9	7	
PAFZZ	2815-781-1954	TUBE ASSEMBLY, METAL: OIL PUMP PICKUP 10935258 (19207)	EA	1	*	*	*	*	*	*	*	9	8	
PAFZZ	2815-871-8473	TUBE ASSEMBLY, METAL: SCAVENGE OIL PUMP INLET 10935259 (19207)	EA	1	*	*	*	*	*	*	*	9	9	
PAFZZ	5305-068-0501	SCREW, CAP, HEXAGON HEAD: BRACKET MTG MS90725-5 (96906)	EA	2	*	*	*	*	*	*	*	9	10	
PAFZZ	5310-761-6882	NUT, FLAIN, HEXAGON: BRACKET MTG MS51967-2 (96906)	EA	2	*	*	*	*	*	*	*	9	11	
PAFZZ	5306-225-8497	BOLT, MACHINE: INLET TUBE TO CARANKCASE MTG MS90725-32 (96906)	EA	2	*	*	*	*	*	*	*	9	12	
PAFZZ	9525-990-7799	WIRE, NICKEL COPPER: OUTLET TUBE TO CRANK- CASE MS20995NC40 (96906)	FT	V	*	*	*	*	*	*	*	9	13	
PAFZZ	5306-753-4322	BOLT, MACHINE: OUTLET TUBE TO CRANKCASE MS51095-334 (96906)	EA	1	*	*	*	*	*	*	*	9	14	
PAFZZ	5306-853-2228	BOLT, MACHINE: OUTLET TUBE TO CRANKCASE MTG MS51093-335 (96906)	EA	1	*	*	*	*	*	*	*	9	15	

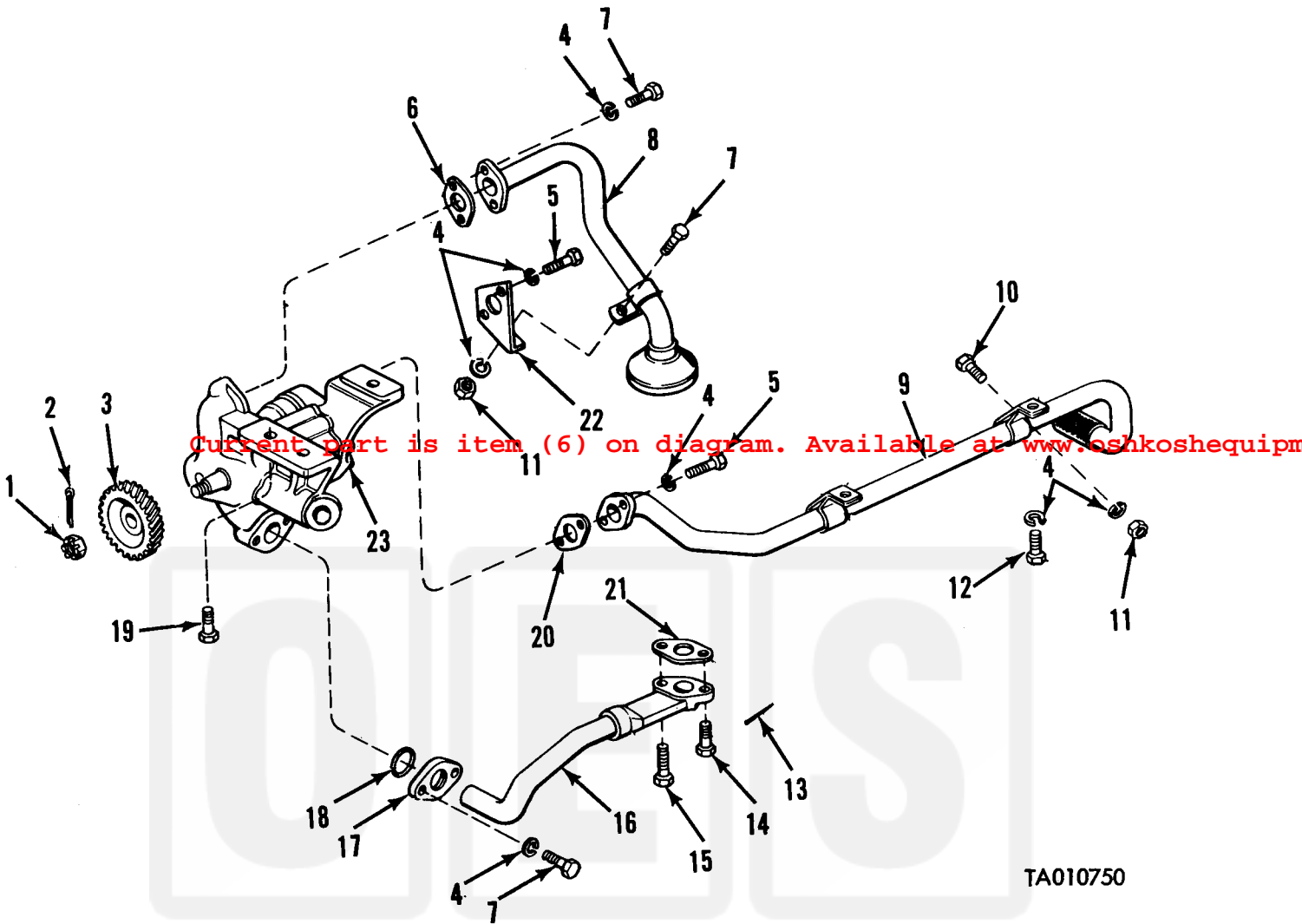

Current part is item (6) on diagram. Available at www.oshkoshequipment.com



TA010750

Figure 9. Oil Pump and Associated Parts.

Oshkosh
Equipment Sales